

Transit Enhancements

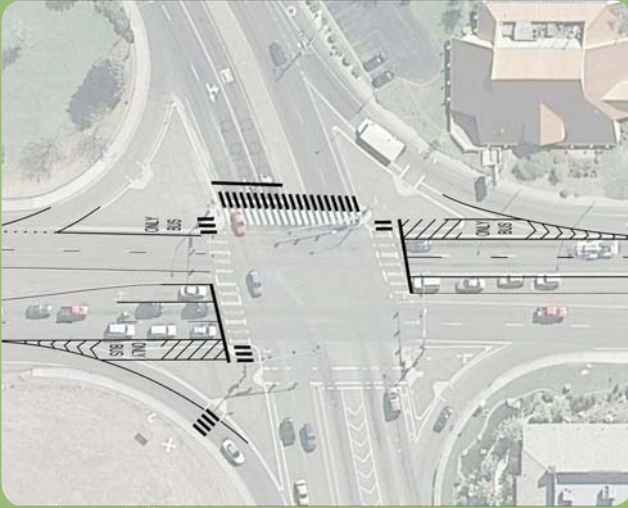

Image Source: Stantec Consulting Services, Inc.

QUEUE JUMP LANES

WHAT IS IT?

- Short bus-only lanes that are provided in advance of a signalized intersection and combined with transit signal priority.

WHAT ARE THE BENEFITS?

- Allows a bus to bypass intersection queuing and re-enter the travel lanes ahead of other vehicles.
- Provides a reduction in travel time for buses along corridors with multiple traffic signals.

Estimated Cost Per Intersection:
\$100,000 - \$300,000*

*Cost does not include Engineering or R.O.W.

TRANSIT SIGNAL PRIORITY

WHAT IS IT?

- Typically applied when using queue jump or bus-only lanes.

WHAT ARE THE BENEFITS?

- Utilize separate signal heads that show white bars, rather than colors, to avoid confusing drivers.
- Can also incorporate sensors that adjust the operation of the signal to allow buses to flow along the corridor with less impedance.

Estimated Cost Per Intersection:
\$8,000 – \$35,000*

*Cost does not include Engineering or R.O.W.



Image Source: Chris Phan October 2005